

PROJECT:

TYPE:

QTY:



2" Square Downlight

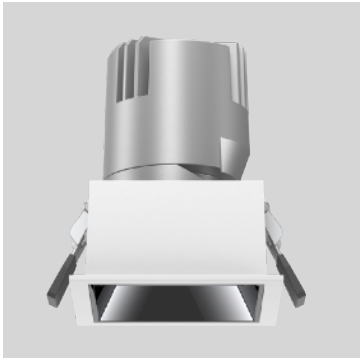

FEATURES

- Modular design, field replaceable LED module, trim, beam lens and accessories.
- Interchangeable secondary reflector options for glare control and maximum visual comfort.
- Quiet ceiling achieved through deep regress.
- Precise light control, 15°/24°/38°/55° TIR lens beam options.
- Offered standard with flicker free dimming to 1% and premium, fade-to-off dimming (.1%), option available.

SPECIFICATIONS

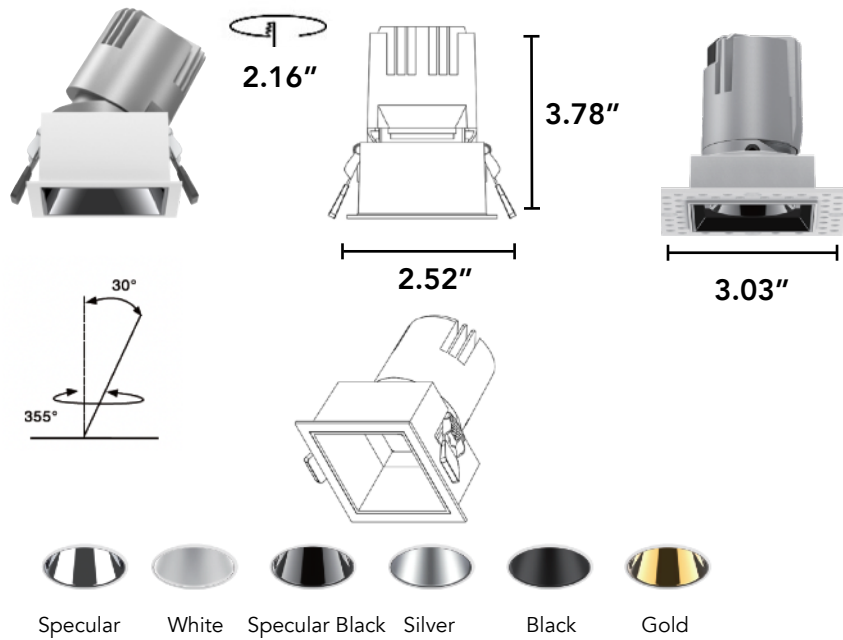

Input Voltage	100-277V AC
Wattage	8W
Delivered Lumens	680Lm-840Lm +/-5%
LED	<3-Step MacAdam Ellipse (2-Step Available)
CCT	27K, 30K, 35K, 40K, D2W, TW
CRI	>90Ra
Beam Angle	TIR Lens 15°/24°/36°/55°
Adjustability	Max Tilt Angle 30° / Horizontal Rotation Angle 355°
Dimming	Trimode Dimming /Triac / 0-10V (100%-1%)
Lamp Life	50,000Hr
Environment	IP44
Operating Temp	-4° F - 104° F

Ordering Code:

Series	Trim		Power		CCT		Beam		Finish		Optical Filter			
Go2LX	2ST - Square Trimmed	F - Fixed	SO	Standard output (8W@85LM/W)	27K -	2700K	10D	10°	Reflector ---- Leave Blank for Wall Wash Pinhole or Slot Trim Options	Trim W - White B - Black C - Custom	SF -	Softening Lens		
	2SL - Square Trimless	A - Adjustable	HO	High output (8W@ 105LM/W)	30K -	3000K	15D	15°			SP -	Specular	HL -	Honeycomb Louver
					35K -	3500K	24D	24°			WH -	White	SO -	Solite Lens
					40K -	4000K	38D	38°			SB -	Specular Black	LS -	Linear Spread Lens
					D2W	3000-1800K	55D	55°			SL -	Silver		
					TW	4500-2700K					BK -	Black		
									GD -	Gold				
									CS -	Custom				

Installation Type		Driver		Emergency	
NC -	New Construction	ELV -	ELV/TRIAC Phase Cutting 3%	EM5 ¹ -	5 watts / 90 mins
IC -	Insulation Contact	D10 -	0/1-10V (100% - 1%)	EM10 ¹ -	10 watts / 90 mins
AT/CP ¹ -	Airtight	FO1 -	0/1-10V (100% - .1%)		
RM	Remodel	DAL -	DALI-2 Dim to off 0.1%		

¹Due to the driver enclosure box size, the EMBB will need to be remote

¹Due to the driver enclosure box size, the EMBB will need to be remote



PROJECT:

TYPE:

QTY:



2" Square Downlight



Performance

90 CRI / 8W	2700K	3000K	3500K	4000
15 Degree	574Lm	598Lm	603Lm	616Lm
24 Degree	587Lm	612Lm	617Lm	630Lm
38 Degree	652Lm	680Lm	686Lm	700Lm
55 Degree	639Lm	666Lm	672:m	686LM

Preliminary, pre-launch test-data. Delivered lumen values +/- 5%. Optical filters will reduce delivered lumen values

Optical Lens



Soft Focus



Honeycomb



Linear Spread

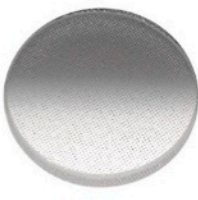

Solite





2" Square Downlight



Mounting Options

NC - New Construction Frame-In Tray

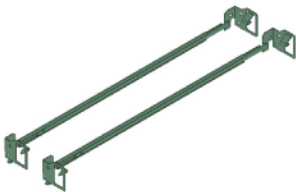
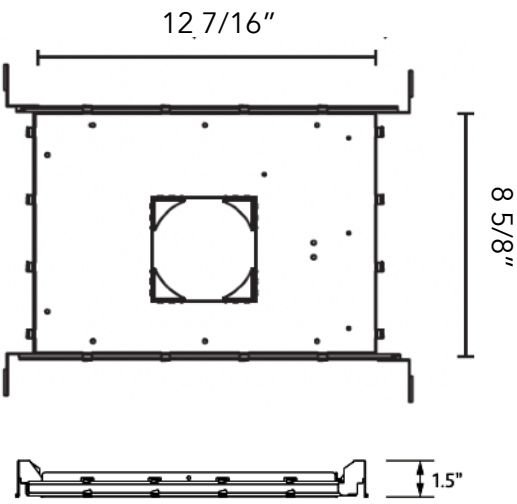

Standard bar hanger (included)
Mounting Length 14 3/4" - 26".
Extension kit can be ordered separately.

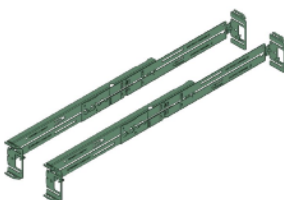

Commercial bar hanger #1487
Butterfly and Caterpillar brackets available



New Construction/Remodel Mounting

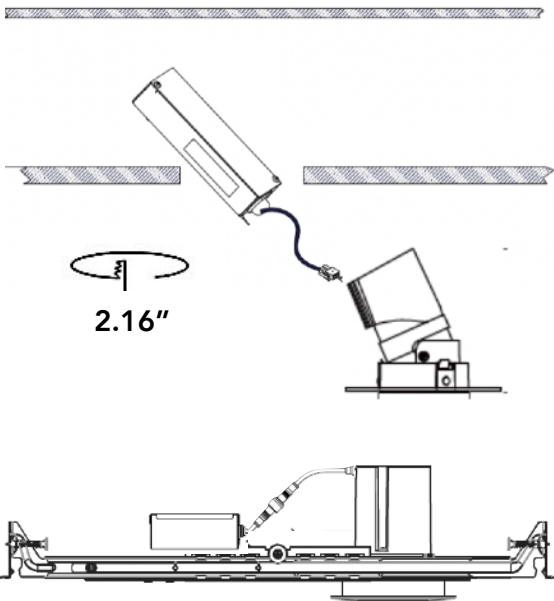

Note: Small fixture housing and driver enclosure box assembly can be used for both new construction and remodel. For remodel application, no new construction tray is needed.

The ceiling cutout opening will be too small to fit your hand through it. So it is very important that the LED driver remains accessible by removing the lighting fixture, thus allowing you to inspect the connectors or LED driver at any time without physically damaging your ceiling or other building materials.

This mounting allows for installation from below the ceiling and full serviceability of the LED driver and driver/junction

LED Driver Enclosure and Junction Box

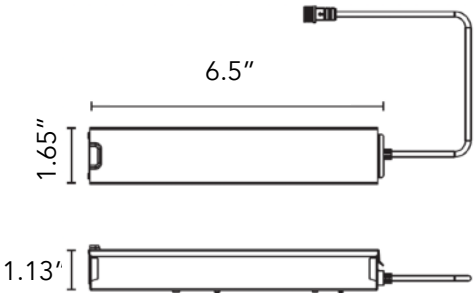

IC / Chicago Plenum / Airtight

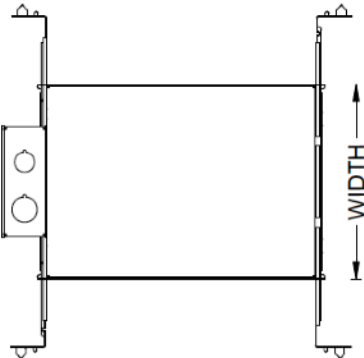
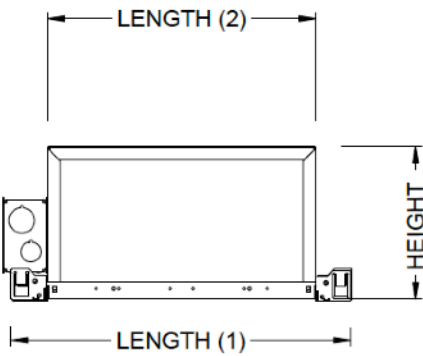

Length	Width	Height
9 3/4"	8 1/2"	3 1/2"





Primary Specifications:

Dimensions / Weight

A 3D perspective diagram of a rectangular object, likely a component of a machine. The object is shown with its front, top, and left side. Four dimensions are indicated with red dimension lines and labels: L (length) along the bottom front edge, W (width) along the top right edge, H (height) along the right vertical edge, and M (depth) along the bottom left edge.

Primary Specifications:

Dimensions / Weight

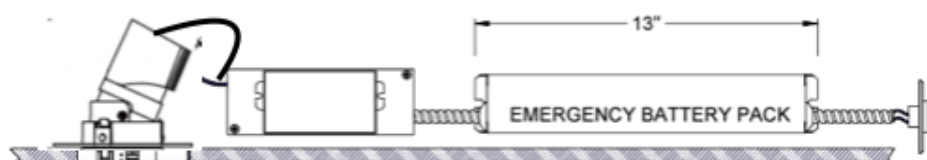

The Remote Test Switch may be mounted adjacent to the LED Fixture by others.

Above ceiling access is recommended for ease of service, but LED Fixture Sizes of 4" and Larger are capable of below ceiling access. IC/ICAT/CP Box and ITS option require an access panel in the ceiling (or other form of access) adjacent to the installation location of the Emergency Battery.

Maximum remote mounting distance of the emergency driver shall be 50 feet.
Remote location wiring provided by others. Follow all Local and National Electric/
Building Codes.

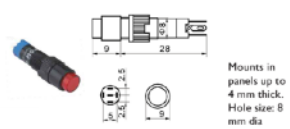

WALL PLATE ACCESSORIES

